	SPECIFICATION # 506-3D77-001
<b>TRANSMISSION &amp; NETWORK</b>	Network Conduit Attachment at Property Line

Date	Written	Approved	Revision
2004-01-04	L. Huynh	G. Fitzpatrick	

Written by: Leonard Huynh

	SPECIFICATION # 506-3D77-001
<b>TRANSMISSION &amp; NETWORK</b>	Network Conduit Attachment at Property Line

## **CONTENTS**

### **1.0 SCOPE**

### **2.0 ATTACHMENT REQUIREMENTS**

#### **2.1 General**

#### **2.2 ENMAX Conduit to Customer Conduit Interface**

#### **2.3 ENMAX Conduit to Customer Building Interface**

#### **2.4 Construction Responsibilities**

##### **2.4.1 New Customer Facility (Customer Responsibilities)**

##### **2.4.2 Existing Customer Facility (ENMAX Responsibilities)**

##### **2.4.3 Customers Facility Does NOT Exist (ENMAX Responsibilities)**

	SPECIFICATION # 506-3D77-001
<b>TRANSMISSION &amp; NETWORK</b>	Network Conduit Attachment at Property Line

**1.0 SCOPE**

The procedures and recommendations in this guideline shall cover the interface point between the ENMAX installed conduit system and the customer's conduit or building wall.

**2.0 ATTACHMENT REQUIREMENTS**

**2.1 General**

ENMAX requires reinforcement to be installed at any location where ENMAX conduit system interfaces with a customer facility at the property line. The reinforcement shall limit vertical movement or sheering action between the ENMAX conduit system and the customer facility.

**2.2 ENMAX Conduit to Customer Conduit Interface**

Reinforcement at any ENMAX conduit duct bank to customer conduit duct bank interface will be done by installing the following:

- A 10 mm diameter reinforcing steel rod will be required under each column of conduit. Refer to the example illustrated below.

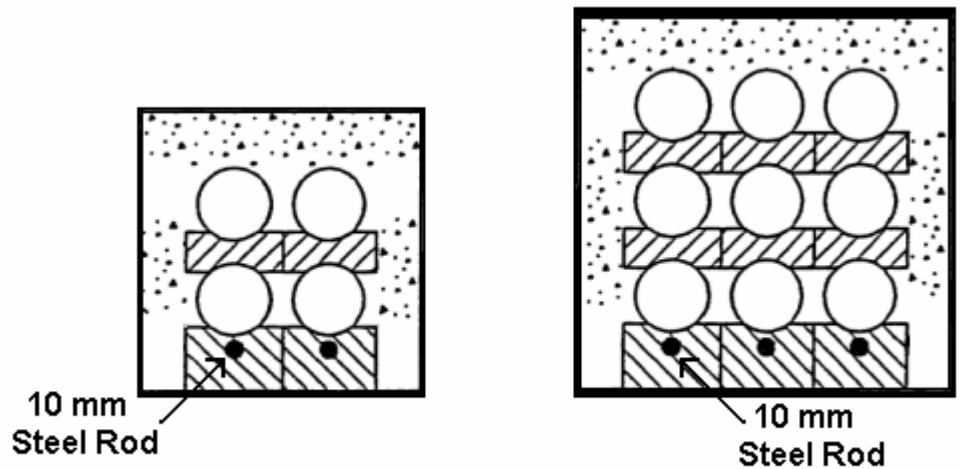

	SPECIFICATION # 506-3D77-001
<b>TRANSMISSION &amp; NETWORK</b>	Network Conduit Attachment at Property Line

### 2.3 ENMAX Conduit to Customer Building Interface

Reinforcement at any ENMAX conduit to customer building interface will be done by installing the following:

- A 10 mm diameter reinforcing steel rod will be required under each column of conduit in the duct bank. Refer to the example illustrated below.
- A 20 mm diameter reinforcing steel rod will be required at each bottom corner of the conduit duct bank. Refer to the example illustrated below.

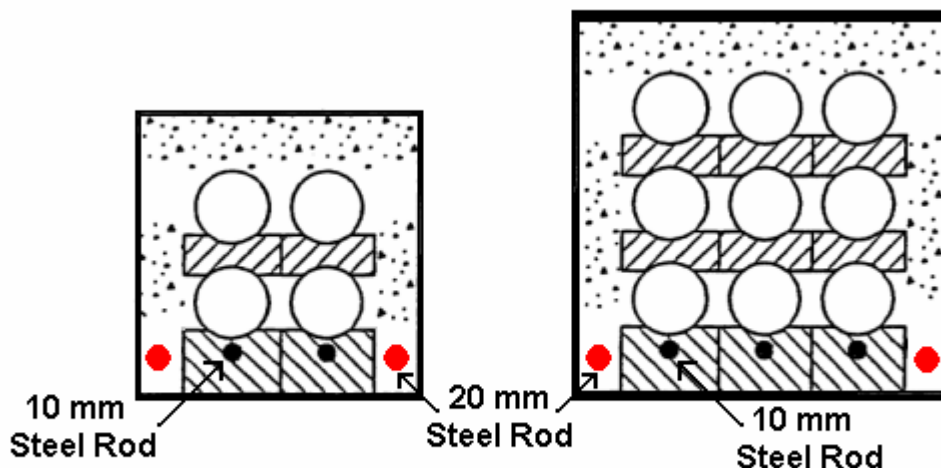

### 2.4 Construction Responsibilities

#### 2.4.1 New Customer Facility (Customer's Responsibilities)

For new customer sites where the ENMAX conduit system is being installed after the customer's building structure or conduit system is completed, the following will be the Customer's responsibility.

- The customer will have all required reinforcing steel rods protruding from their facility in the configurations outlined in Section 2.2 and 2.3 when completed. The reinforcing steel rods will be connected to the reinforcing steel in the ENMAX conduit system by ENMAX .

	SPECIFICATION # 506-3D77-001
<b>TRANSMISSION &amp; NETWORK</b>	Network Conduit Attachment at Property Line

**2.4.2 Existing Customer Facility (ENMAX Responsibilities)**

For customer sites where the ENMAX conduit system is being upgraded and the customer's building or conduit system already exists; the following will be performed by ENMAX:

- ENMAX will dowel into the customer's facility and install reinforcing steel as outlined in the Section 2.2 and 2.3. The reinforcing steel rods will then be epoxied into place and interconnected to the reinforcing steel in the ENMAX conduit system.

**2.4.3 Customers Facility Does NOT Exists (ENMAX Responsibilities)**

In situations were the ENMAX conduit system is installed prior to the construction of the customers building, structure or conduit system, the following will be performed by ENMAX:

Reinforcing steel rods in the configuration outlined in Section 2.2 and 2.3 will be left protruding from the end of the ENMAX conduit duct bank to permit the Customer to tie their facility to the ENMAX conduit system .